



Installation Instructions

LR-LT Lockable Trimmer Rack

Before you begin installing:

1. Read and understand these instructions completely.
2. Verify that you have received all the parts listed in the bill of materials.

ITEM	QTY.	DESCRIPTION
1.	(1)	Post, Vertical Nonlocking. Trimmer Back
2.	(2)	Plug, Plastic Finish, 1" Sq Tube
3.	(6)	Guide. Spring
4.	(6)	Spring. Torsion Trimmer Back
5.	(3)	Hook, Grip Pivot
6.	(6)	Screw, HHC 5/16-18x2-3/4" Gr5 Zn
7.	(6)	Nut, Nylock 5/16-18 Zn
8.	(1)	Tube, Vertical, Locking, Welded
9.	(3)	Hook, Pivot
10.	(1)	Lock, Trimmer Rack, Finished
11.	(2)	Washer, Flat 1/2" SAE Zn
12.	(2)	Nut, Nylock 1/2-13 Zn
13.	(1)	Angle, Top Connecting, LT10
14.	(14)	Washer, Flat 3/8" USS Zn
15.	(4)	Screw, HHC 3/8-16x2 Gr5 Zp
16.	(4)	Screw, HHC 3/8-16x2-1/2 Gr5 Zp
17.	(8)	Nut, Nylock 3/8-6x7/16 Zn

Tools Required:

- (2) 9/16"
- Wrenches and/or Sockets
- Electric Drill
- 13/32" Drill Bit
- Carpenter's Square
- Tape Measure
- (2) C-clamps
- Hack Saw

WARNING

Always wear safety glasses when using power tools.

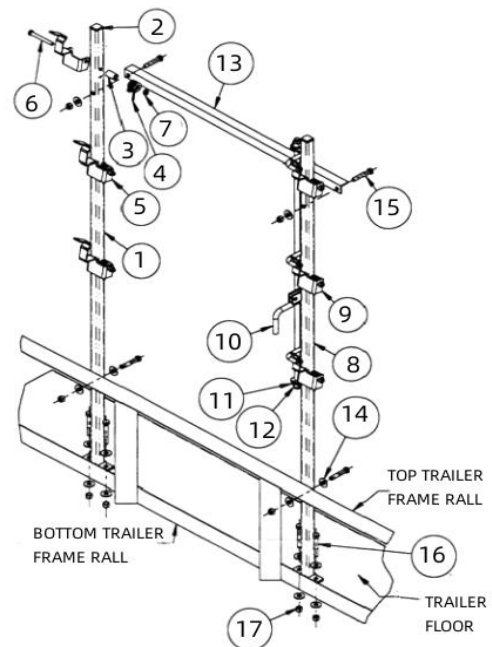

WARNING

Check for locations of brake lines and electrical wiring etc., before drilling any holes. Any damage to trailer during installation is the installer's sole responsibility.

1. Clamp the locking and nonlocking uprights to the trailer side rail approximately 28" to 34" apart with the base of the upright on the trailer floor. The locking upright may be assembled on the left or right of the nonlocking upright. Verify the uprights are square to the trailer deck in both directions with a carpenter's square.

Note: If bent shaft trimmers are used, the uprights need to be mounted closer together than if straight shaft trimmers are used.

2. Assemble a line trimmer to the rack to verify the distance between the uprights is correct for the model of trimmer you wish to hold. The large hook on the non-locking upright should engage the trimmer's grip and the smaller hook on the locking upright should engage the shaft of the trimmer. **Do not clamp on or near the throttle trigger of the trimmer.** With the trimmer assembled in position, verify that the lock assembly can rotate freely over the trimmer shaft

- 3.** After determining the position of the uprights, mark center of the two holes in each upright base on the trailer deck.
- 4.** Remove the uprights from the trailer and use a 13/32" drill bit to drill four holes in your trailer deck as marked
- 5.** Assemble the uprights to the trailer with four 3/8-16 x2-1/2" cap screws, eight 3/8" flat washers and four 3/8-16 nylock nuts. Do not tighten screws at this time! Clamp the two uprights to the rail of the trailer. Make sure the uprights are square to the rail and the deck of the trailer with a square.
- 6.** With the uprights clamped into position drill a 13/32" hole through the center of each upright and the trailer rail. Fasten each upright to the trailer rail with a 3/8-16 x2" cap screw, two 3/8" flat washers, and a 3/8-16 nylock nut. Tighten all six screws.
- 7.** Loosely assemble the top connecting angle to an upright using hardware supplied and hold horizontally. Mark the angle on the outside of the second upright. Remove and cut off excess material.
- 8.** Drill a 13/32" hole in the center of the angle's web 1/2" from the end of the angle.
- 9.** Assemble top connecting angle using two 3/8-16 x2" cap screws, two 3/8" flat washers and two 3/8-16 nylock nuts and tighten.