



American Bureau of Shipping

Container Corner Casting Production Certificate

(This Certificate is valid only when endorsed by an ABS Surveyor)

Date: 7 August 2019

Certificate No.: SQ3705344-F

Design Type No.: AB/CCC- 502 / 05 -

THIS IS TO CERTIFY that the herein described Container Corner Castings have been manufactured and tested in accordance with the American Bureau of Shipping Rules for Certification of Cargo Containers and with dimensional requirements of ISO 1161.

Manufacturer: [REDACTED]

Purchaser: MYTEE PRODUCTS

These corner castings were manufactured in accordance with drawings reviewed on Aug 11, 2005

Reference no. T-8-7 5705, under General Arrangement drawing number FTXJ.01.02.03.04

This certificate is for 50 sets of corner castings, model number FTX-ISO, manufactured during the month of July 2019. These corner castings comply with material specification ZG16Mn

as evidenced by the chemical and mechanical test data attached to this certificate.

Nondestructive Testing: Radiographic	<input type="checkbox"/>	Heat Treatment Condition: Annealed	<input type="checkbox"/>
Ultrasonic	<input checked="" type="checkbox"/>	Normalized	<input checked="" type="checkbox"/>
		Normalized and tempered	<input type="checkbox"/>

These castings have been thoroughly inspected and tested at each stage of manufacture by our inspection department under quality control surveillance of the American Bureau of Shipping and are marked as follows:

Serial/heat

No.: See attached manufacturer's certificate no. FTC190807-F Dated 2019.08

7 August 2019

Date

Zhang Ping In Charge of Quality Control

品 质 部

The undersigned has carried out quality control surveillance at the above plant and considers these corner castings to be eligible to become part of an ABS/ISO certified container.

7 August 2019

Date

Chen Gang(7118) Surveyor



NOTE: This Certificate evidences compliance with one or more of the rules, guides, standards or other criteria of American Bureau of Shipping and is issued solely for the use of the bureau, its committees, its clients or authorized entities. This Certificate is a representation only that the vessel, structure, item of material, equipment, machinery or any other item covered by this Certificate has been examined for compliance with, or has met one or more of the Rules, guides, standards or other criteria of American Bureau of Shipping. The validity, applicability and interpretation of this Certificate is governed by the Rules and Standards of American Bureau of Shipping which shall remain sole judge thereof. Nothing contained in this Certificate or in any Report issued in contemplation of this Certificate shall be deemed to relieve any designer, builder, owner, manufacturer, seller, supplier, repairer, operator or other entity of any warranty express or implied.

扬州富通机械有限公司



集装箱铸造角件产品检验合格证书

Certificate of inspection eligible of container corner casting

检定证号: **FTC190807-F**

设计型号: AB/CCC-502/05

Number of certificate of inspection

Design Type:

用户: MYTEE PRODUCTS

炉 50 套

该份检验证书适用: 2190717-2190720

Furnace Sets

It's suited to:

制造日期:

2019 年 7 月

Date of manufactured:

材料牌号: ZG16Mn

炉号 Number of furnace		炉号 Number of furnace	
化学成分 Chemical composition		机械性能 Mechanical property	
碳 C max	0.20%	抗拉强度 Tensile (N/m ²) σ_b	480
锰 Mn max	0.9 -1.5%	屈服强度 Yield (N/m ²) σ_s min	275
硅 Si max	0.50%	延伸率 Elongation(%) δ_s min	25%
硫 S max	0.035%	断面收缩率 Reduction of area (%) min	40%
磷 P max	0.035%	冲击 -40°C min	21J

识别标志:

FT

Identification marking:

无损检验:

超声波探伤

X-光探伤

Non-damage Inspection:

Ultrasonic

X-ray

热处理工艺:

Heat treatment technology:

920°C

空 冷

正火

Cooling in air

Normalized



签字 Signature: 郑业亮



日期 Date. 2019.08

扬州富通机械有限公司

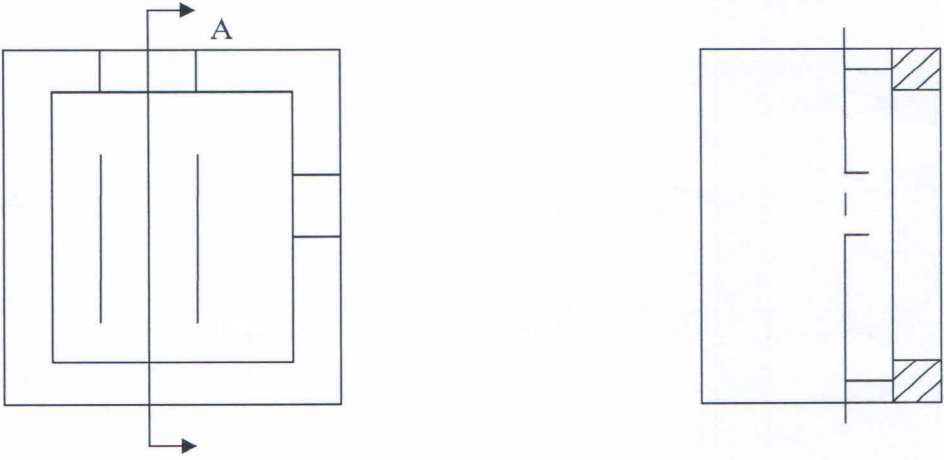
Ultrasonic-Inspection Record

名称 Name	Corner Casting	型号 Type	TL BR	炉号 Number of Furnace	2190717-2190720		
材质 Material	ZG16Mn	规格 Norms	20.28	检查范围 Scope of Inspection	1/400		
热处理状况 Condition of heat treatment	Modified	仪器型号 Instrument Type	PFUT-260/280	耦合剂 Chemical Prepsration of coupling	Machine oil		
探伤灵敏度 Flaw detection Sensitivity	6.35	探测频率 Survey frequency	2.5MHz	探伤方式 Way of Detection	A	扫描调节 Regulating Of scanning	1:1
检验产品定位示意图 Location Sketch Map of Inspection Product							
检测结论 Pection Clusion	<p>按 <u>ASTM-A609 / A609M-86a</u> 级标准验收合格</p> <p>产品符合 ISO1161-2016(E)要求</p> <p>Checking and accepting to <u>ASTM-A609 /A609M-86a</u> standard</p> <p>After Ultrasonic inspection none of ultra poor defective wave is displayed</p>						
初探 Early detection	徐文高	复探 Again detection			日期 Date	2019.07	

Handwritten signature

扬州富通机械制造有限公司尺寸检查表

DIMENSION CHECK SHEET

日期: DATE: 2019.07

报告发往: Report to:		MYTEE PRODUCTS																	
物品名称: Name of Article		集装箱角件 CORNER CASTING																	
图号: Drawing No.:		FTXJ03, 04																	
材料: Material:		ZG16Mn																	
总数量: Total quantity:		50套	检测数量										100%						
委托号: Charge No.:																			
项目	标准	公差	-1.5	-1.0	-0.5	0	0.5	+1.0	+1.5										
Item	Standard	Allowance																	
1	178	-1				*	*	*	*										
2	162	±0.5				*	*	*	*										
3	118	-1				*	*	*	*										
4	φ124	+1.5				*	*	*	*										
5	63.5	+1.5				*	*	*	*										
6	79.5	+1.5				*	*	*	*										
7	51	+1.5				*	*	*	*										
8	28.5	-1.5	*	*	*	*	*	*	*										
9	79.5	+1.5				*	*	*	*										
10	51	+1.5				*	*	*	*										
11	28.5	-1.5	*	*	*	*	*	*	*										
12	101.5	-1.5	*	*	*	*	*	*	*										
13	89	-1.5	*	*	*	*	*	*	*										
14	20.5	-1.5	*	*	*	*	*	*	*										
15	20.5	-1.5	*	*	*	*	*	*	*										

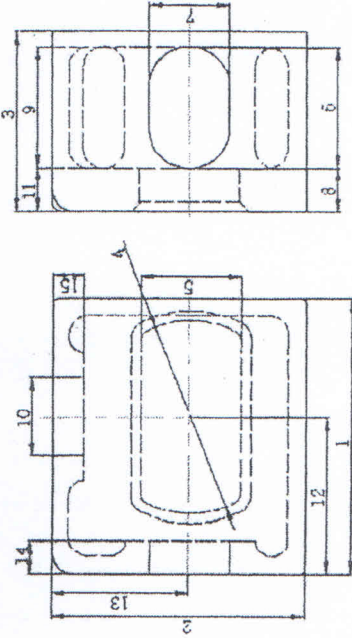

复査 检查人 傅永东
 Check to 吴仲元
 验船师 2019.08
 Surveyor
 品 质 部
 Quality Control Department



American Bureau of Shipping

Container Corner Casting Production Certificate

(This Certificate is valid only when endorsed by an ABS Surveyor)

Date: 6 November 2019

Certificate No.: SQ3750913-J

Design Type No.: AB/CCC- 502 / 05 -

THIS IS TO CERTIFY that the herein described Container Corner Castings have been manufactured and tested in accordance with the American Bureau of Shipping Rules for Certification of Cargo Containers and with dimensional requirements of ISO 1161.

Manufacturer: [REDACTED]

Purchaser: MYTEE PRODUCTS

These corner castings were manufactured in accordance with drawings reviewed on Aug 11,2005

Reference no. T-8-7 5705 , under General Arrangement drawing number FTXJ.01.02.03.04

This certificate is for 25 sets of corner castings, model number FTX-ISO , manufactured during the month of October 2019 . These corner castings comply with material specification SCW480

as evidenced by the chemical and mechanical test data attached to this certificate.

Nondestructive Testing: Radiographic
Ultrasonic

Heat Treatment Condition:

Annealed
Normalized
Normalized and tempered

These castings have been thoroughly inspected and tested at each stage of manufacture by our inspection department under quality control surveillance of the American Bureau of Shipping and are marked as follows:

Serial/heat

No.: See attached manufacturer's certificate no.FTC191106-J Dated 2019.10

6 November 2019

Date

Zhang Ping In Charge of Quality Control

The undersigned has carried out quality control surveillance at the above plant and considers these corner castings to be eligible to become part of an ABS/ISO certified container.

6 November 2019

Date



Chen Gang(7118) Surveyor

NOTE: This Certificate evidences compliance with one or more of the rules, guides, standards or other criteria of American Bureau of Shipping and is issued solely for the use of the bureau, it's committees, it's clients or authorized entities. This Certificate is a representation only that the vessel, structure, item of material, equipment, machinery or any other item covered by this Certificate has been examined for compliance with, or has met one or more of the Rules, guides, standards or other criteria of American Bureau of Shipping. The validity, applicability and interpretation of this Certificate is governed by the Rules and Standards of American Bureau of shipping which shall remain sole judge thereof. Nothing contained in this Certificate or in any Report issued in contemplation of this Certificate shall be deemed to relieve any designer, builder, owner, manufacturer, seller, supplier, repairer, operator or other entity of any warranty express or implied.

ABS Certificate NO: SQ3750913-J

扬州富通机械有限公司

Reviewed By ABS



集装箱铸造角件产品检验合格证书

Certificate of inspection eligible of container corner casting

检定证号: **FTC191106-J**

设计型号: AB/CCC-502/05

Number of certificate of inspection

Design Type:

用户: MYTEE PRODUCTS

炉 25 套

Furnace Sets

该份检验证书适用: 2190925-2190926

It's suited to:

2019 年 10 月

制造日期:

Date of manufactured:

材料牌号: SCW480

炉号 Number of furnace	化学成分 Chemical composition	炉号 Number of furnace	机械性能 Mechanical property
	碳 C max	0.20%	抗拉强度 Tensile (N/m ²) σ_b 480
	锰 Mn max	0.9 -1.5%	屈服强度 Yield (N/m ²) σ_s min 275
	硅 Si max	0.50%	延伸率 Elongation(%) δ_s min 25%
	硫 S max	0.035%	断面收缩率 Reduction of area (%) min 40%
	磷 P max	0.035%	冲击 -40°C min 21J

识别标志:

FT

Identification marking:

无损检验:

超声波探伤

X-光探伤

Non-damage Inspection:

Ultrasonic

X-ray

热处理工艺:

Heat treatment technology:

920°C

空冷

正火

Cooling in air

Normalized

签字 Signature: 郑业亮



日期 Date. 2019.10

扬州富通机械有限公司

Ultrasonic-Inspection Record

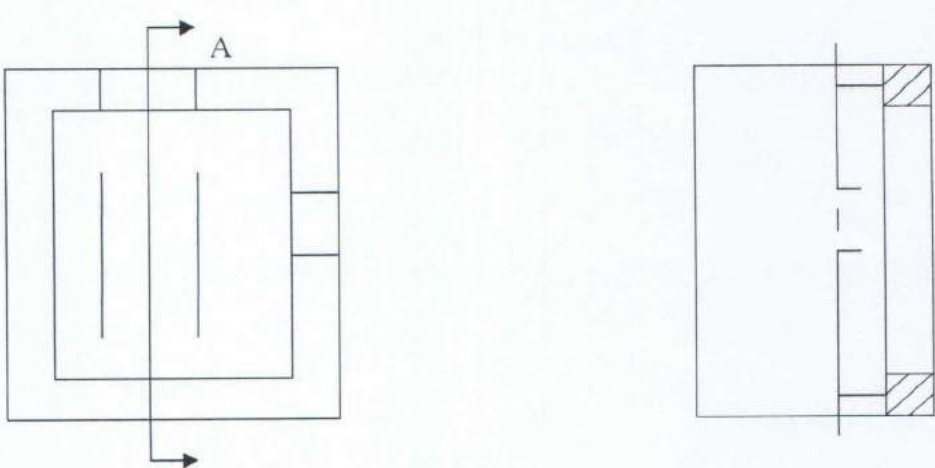
名称 Name	Corner Casting	型号 Type	TR BL	炉号 Number of Furnace	2190925-2190926	
材质 Material	SCW480	规格 Norms	20.28	检查范围 Scope of Inspection	1/400	
热处理状况 Condition of heat treatment	Modified	仪器型号 Instrument Type	PFUT-260/280	耦合剂 Chemical Prepsration of coupling	Machine oil	
探伤灵敏度 Flaw detection Sensitivity	6.35	探测频率 Survey frequency	2.5MHz	探伤方式 Way of Detection	A	扫描调节 Regulating Of scanning
1:1						
检验产品定位示意图 Location Sketch Map of Inspection Product						
检测结论 Pection Clusion	<p>按 ASTM-A609 / A609M-86a 级标准验收合格</p> <p>产品符合 ISO1161-2016(E)要求</p> <p>Checking and accepting to <u>ASTM-A609 / A609M-86a</u> standard</p> <p>After Ultrasonic inspection none of ultra poor defective wave is displayed</p>					
初探 Early detection	徐兴高	复探 Again detection	曹金亮 专用章		日期 Date	2019.10

Signature

扬州富通机械制造有限公司尺寸检查表

DIMENSION CHECK SHEET

日期: DATE: 2019.10

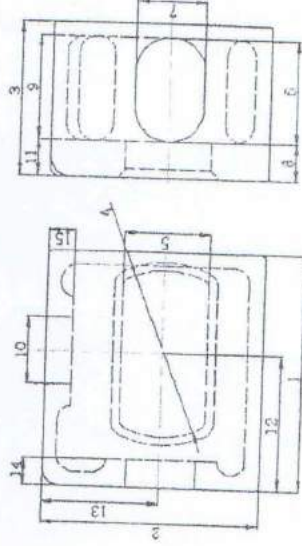

报告发往: Report to:	MYTEE PRODUCTS	
物品名称: Name of Article	集装箱角件 CORNER CASTING	
图号: Drawing No.:	FTXJ03, 04	
材料: Material:	SCW480	
总数量: Total quantity:	25套	检测数量 Inspection Quantity
委托号: Charge No.:	100%	

项目 Item	标准 Standard	公差 Allowance	-1.5	-1.0	-0.5	0	0.5	+1.0	+1.5
1	178	-1	*	*	*	*	*	*	*
2	162	±0.5	*	*	*	*	*	*	*
3	118	-1	*	*	*	*	*	*	*
4	φ124	+1.5	*	*	*	*	*	*	*
5	63.5	+1.5	*	*	*	*	*	*	*
6	79.5	+1.5	*	*	*	*	*	*	*
7	51	+1.5	*	*	*	*	*	*	*
8	28.5	-1.5	*	*	*	*	*	*	*
9	79.5	+1.5	*	*	*	*	*	*	*
10	51	+1.5	*	*	*	*	*	*	*
11	28.5	-1.5	*	*	*	*	*	*	*
12	101.5	-1.5	*	*	*	*	*	*	*
13	89	-1.5	*	*	*	*	*	*	*
14	20.5	-1.5	*	*	*	*	*	*	*
15	20.5	-1.5	*	*	*	*	*	*	*

复查: 吴永芳
 Check to: 吴永芳
 验船师: 吴永芳
 Surveyor: 吴永芳
 日期: 2019.11.6
 品 质 部
 Quality Control Department

扬州富通机械制造有限公司尺寸检查表

LTD DIMENSION CHECK SHEET

日期: DATE: 2019.10

报告发往: Report to:	MYTEE PRODUCTS	
物品名称: Name of Article	集装箱角件 CORNER CASTING	
图号: Drawing No.:	FTXJ01.02	
材料: Material:	SCW480	
总数量: Total quantity:	25套	检测数量 Inspection Quantity
委托号: Charge No.:		100%

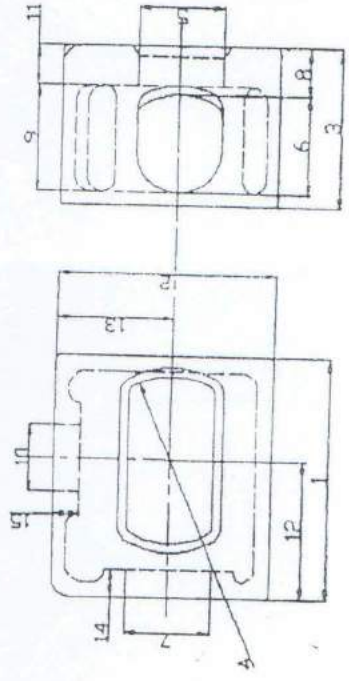

项目 Item	标准 Standard	公差 Allowance	-1.5	-1.0	-0.5	0	+0.5	+1.0	+1.5
1	178	-1	*	*	*	*	*	*	*
2	162	±0.5	*	*	*	*	*	*	*
3	118	-1	*	*	*	*	*	*	*
4	φ124	+1.5	*	*	*	*	*	*	*
5	63.5	+1.5	*	*	*	*	*	*	*
6	79.5	+1.5	*	*	*	*	*	*	*
7	63.5	+1.5	*	*	*	*	*	*	*
8	28.5	-1.5	*	*	*	*	*	*	*
9	79.5	+1.5	*	*	*	*	*	*	*
10	51	+1.5	*	*	*	*	*	*	*
11	28.5	-1.5	*	*	*	*	*	*	*
12	101.5	-1.5	*	*	*	*	*	*	*
13	89	-1.5	*	*	*	*	*	*	*
14	20.5	-1.5	*	*	*	*	*	*	*
15	20.5	-1.5	*	*	*	*	*	*	*



检查人
Rummager

复查
Check to

孙晓

验船师
Surveyor

2019.11.6

品 质 部
Quality Control Department



American Bureau of Shipping

Container Corner Casting Production Certificate

(This Certificate is valid only when endorsed by an ABS Surveyor)

Date: 18 March 2020

Certificate No.: SQ4201803-1

Design Type No.: AB/CCC- 502 / 05

THIS IS TO CERTIFY that the herein described Container Corner Castings have been manufactured and tested in accordance with the American Bureau of Shipping Rules for Certification of Cargo Containers and with dimensional requirements of ISO 1161.

Manufacturer: [REDACTED]

Purchaser: MYTEE PRODUCTS

These corner castings were manufactured in accordance with drawings reviewed on Aug 11, 2005

Reference no: T-8-7 5705 under General Arrangement drawing number FTXJ.01.02.03.04

This certificate is for 50 sets of corner castings, model number FTX-ISO, manufactured during the month of March 2020. These corner castings comply with material specification SCW480

as evidenced by the chemical and mechanical test data attached to this certificate.

Nondestructive Testing:	Radiographic <input type="checkbox"/>	Heat Treatment Condition:	Annealed <input type="checkbox"/>
	Ultrasonic <input checked="" type="checkbox"/>		Normalized <input checked="" type="checkbox"/>
			Normalized and tempered <input type="checkbox"/>

These castings have been thoroughly inspected and tested at each stage of manufacture by our inspection department under quality control surveillance of the American Bureau of Shipping and are marked as follows:

Serial/heat No.: See attached manufacturer's certificate no. FTC200318-I Dated 2020.03

18 March 2020
Date

Zhang Ping In Charge of Quality Control

The undersigned has carried out quality control surveillance at the above plant and considers these corner castings to be eligible to become part of an ABS/ISO certified container.

18 March 2020
Date



Chen Gang
Chen Gang(7118) Surveyor

NOTE: This Certificate evidences compliance with one or more of the rules, guides, standards or other criteria of American Bureau of Shipping and is issued solely for the use of the bureau, its committees, its clients or authorized entities. This Certificate is a representation only that the vessel, structure, item of material, equipment, machinery or any other item covered by this Certificate has been examined for compliance with, or has met one or more of the Rules, guides, standards or other criteria of American Bureau of Shipping. The validity, applicability and interpretation of this Certificate is governed by the Rules and Standards of American Bureau of Shipping which shall remain sole judge thereof. Nothing contained in this Certificate or in any Report issued in contemplation of this Certificate shall be deemed to relieve any designer, builder, owner, manufacturer, seller, supplier, receiver, operator or other entity of any warranty express or implied.

扬州富通机械有限公司



集装箱铸造角件产品检验合格证书

Certificate of inspection eligible of container corner casting

检定证号: **FTC200318-I**

设计型号: AB/CCC-502/05

Number of certificate of inspection

Design Type:

用户: MYTEE PRODUCTS

炉 50 套

该份检验证书适用: 2200305-2200308

Furnace Sets

It's suited to:

制造日期:

2020 年 3 月

Date of manufactured:

材料牌号: SCW480

炉号 Number of furnace		炉号 Number of furnace	
化学成分 Chemical composition		机械性能 Mechanical property	
碳 C max	0.20%	抗拉强度 Tensile (N/m ²) σ_b	480
锰 Mn max	0.9 -1.5%	屈服强度 Yield (N/m ²) σ_s min	275
硅 Si max	0.50%	延伸率 Elongation(%) δ_5 min	25%
硫 S max	0.035%	断面收缩率 Reduction of area (%) min	40%
磷 P max	0.035%	冲击 -40°C min	21J

识别标志:

FT

Identification marking:

无损检验:

超声波探伤 X-光探伤

Non-damage Inspection:

Ultrasonic

X-ray

热处理工艺:

Heat treatment technology:

920°C

空 冷

正火

Cooling in air

Normalized

签字 Signature: 郑业亮

日期 Date: 2020.03



扬州富通机械有限公司

Ultrasonic-Inspection Record

名称 Name	Comer Casting	型号 Type	BRBL	炉号 Number of Furnace	2200305-2200308	
材质 Material	SCW480	规格 Norms	20.28	检查范围 Scope of Inspection	1/400	
热处理状况 Condition of heat treatment	Modified	仪器型号 Instrument Type	PFUT-260/280	耦合剂 Chemical Prepsration of coupling	Machine oil	
探伤灵敏度 Flaw detection Sensitivity	6.35	探测频率 Survey frequency	2.5MHz	探伤方式 Way of Detection	A	扫描调节 Regulating Of scanning 1:1
检验产品定位示意图 Location Sketch Map of Inspection Product						
检测结论 Pection Clusion	<p>按 <u>ASTM-A609 / A609M-86a</u> 级标准验收合格</p> <p>产品符合 ISO1161-2016(E)要求</p> <p>Checking and accepting to <u>ASTM-A609 / A609M-86a</u> standard</p> <p>After Ultrasonic inspection none of ultra poor defective wave is displayed</p>					
初探 Early detection	徐文高	复探 Again detection	曹金亮		日期 Date	2020.03



扬州富通机械制造有限公司尺寸检查表

DIMENSION CHECK SHEET

日期: DATE: 2020.03

报告发往: Report to:

MYTEE PRODUCTS

物品名称: Name of Article

集装箱角件 CORNER CASTING

图号: Drawing No.:

FTXJ01.02

材料: Material:

SCW480

总数量: Total quantity:

50套

检测数量

100%

委托号: Charge No.:

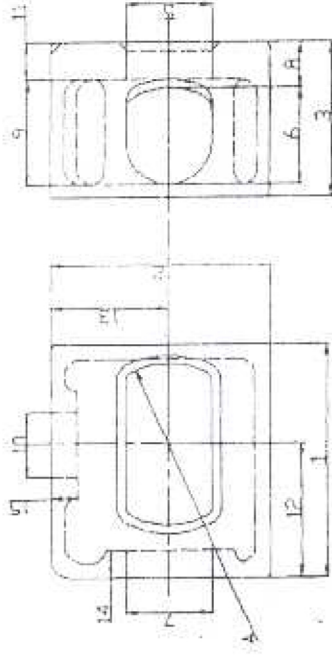

项目	标准	公差	1.5	-1.0	-0.5	0	+0.5	+1.0	1.5
Item	Standard	Allowance							
1	178	-1	*	*	*	*	*	*	*
2	162	±0.5	*	*	*	*	*	*	*
3	118	-1	*	*	*	*	*	*	*
4	φ124	+1.5	*	*	*	*	*	*	*
5	63.5	±1.5	*	*	*	*	*	*	*
6	79.5	+1.5	*	*	*	*	*	*	*
7	63.5	+1.5	*	*	*	*	*	*	*
8	28.5	1.5	*	*	*	*	*	*	*
9	79.5	+1.5	*	*	*	*	*	*	*
10	51	±1.5	*	*	*	*	*	*	*
11	28.5	1.5	*	*	*	*	*	*	*
12	101.5	-1.5	*	*	*	*	*	*	*
13	89	-1.5	*	*	*	*	*	*	*
14	20.5	-1.5	*	*	*	*	*	*	*
15	20.5	-1.5	*	*	*	*	*	*	*

检查人

焦永芳

复查

Check to:

郭晓航

验船师

Surveyor

品质部

Quality Control Department

2020.3.18

扬州富通机械制造有限公司尺寸检查表

DIMENSION CHECK SHEET

日期: DATE: 2020.03

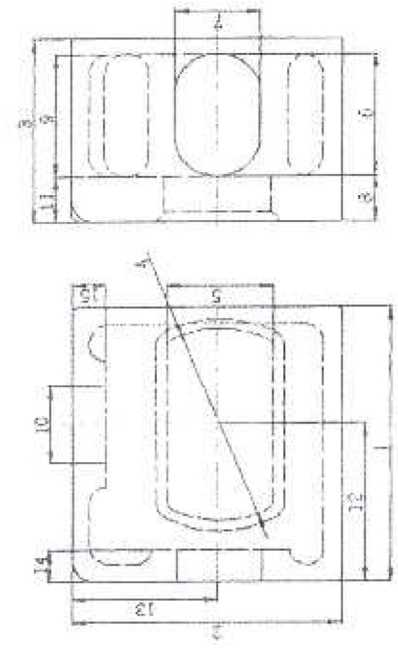

报告发往: Report to: MYTEE PRODUCTS

物品名称: Name of Article 集装箱角件 CORNER CASTING

图号: Drawing No.: FTX103, 04

材料: Material: SCW480

总数量: Total quantity: 50套 Inspection Quantity 100%

委托号: Charge No.:

项目	标准	公差	-1.5	1.0	0.5	0	0.5	+1.0	+1.5
Item	Standard	Allowance							
1	178	-1		*	*	*	*	*	*
2	162	±0.5		*	*	*	*	*	*
3	118	-1		*	*	*	*	*	*
4	φ124	+1.5					*	*	*
5	63.5	+1.5					*	*	*
6	79.5	+1.5					*	*	*
7	51	+1.5					*	*	*
8	28.5	-1.5	*	*	*	*	*	*	*
9	79.5	+1.5					*	*	*
10	51	+1.5					*	*	*
11	28.5	-1.5	*	*	*	*	*	*	*
12	101.5	-1.5	*	*	*	*	*	*	*
13	89	1.5	*	*	*	*	*	*	*
14	20.5	1.5	*	*	*	*	*	*	*
15	20.5	1.5	*	*	*	*	*	*	*

检查人: 焦永华
 Rounnager: 焦永华
 复查: 郑晓
 Check to: 郑晓
 验船师: 2020.3.18
 Surveyor: 2020.3.18
 品 质 部
 Quality Control Department



American Bureau of Shipping

Container Corner Casting Production Certificate

(This Certificate is valid only when endorsed by an ABS Surveyor)

Date: 26 January 2021

Certificate No.: SQ4608144-A

Design Type No.: AB/CCC- 502 / 05

THIS IS TO CERTIFY that the herein described Container Corner Castings have been manufactured and tested in accordance with the American Bureau of Shipping Rules for Certification of Cargo Containers and with dimensional requirements of ISO 1161-2016(E).

Manufacturer: [REDACTED]

Purchaser: MYTEE PRODUCTS

These corner castings were manufactured in accordance with drawings reviewed on Aug 11,2005

Reference no. T-8-7 5705, under General Arrangement drawing number FTXJ.01.02.03.04

This certificate is for 112.5 sets of corner castings, model number FTX-ISO, manufactured during the month of December 2020. These corner castings comply with material specification SCW480

as evidenced by the chemical and mechanical test data attached to this certificate.

Nondestructive Testing: Radiographic Ultrasonic Heat Treatment Condition: Annealed Normalized Normalized and tempered

These castings have been thoroughly inspected and tested at each stage of manufacture by our inspection department under quality control surveillance of the American Bureau of Shipping and are marked as follows:

Serial/heat

No.: See attached manufacturer's certificate no.FTC210126-A Dated 2021.01

26 January 2021

Date

Zhang Ping In Charge of Quality Control

The undersigned has carried out quality control surveillance at the above plant and considers these corner castings to be eligible to become part of an ABS/ISO certified container.

26 January 2021

Date

Chen Gang(7118) Surveyor



NOTE: This Certificate evidences compliance with one or more of the rules, guides, standards or other criteria of American Bureau of Shipping and is issued solely for the use of the bureau, its committees, its clients or authorized entities. This Certificate is a representation only that the vessel, structure, item of material, equipment, machinery or any other item covered by this Certificate has been examined for compliance with, or has met one or more of the Rules, guides, standards or other criteria of American Bureau of Shipping. The validity, applicability and interpretation of this Certificate is governed by the Rules and Standards of American Bureau of Shipping which shall remain sole judge thereof. Nothing contained in this Certificate or in any Report issued in contemplation of this Certificate shall be deemed to relieve any designer, builder, owner, manufacturer, seller, supplier, repairer, operator or other entity of any warranty express or implied.

扬州富通机械有限公司



集装箱铸造角件产品检验合格证书

Certificate of inspection eligible of container corner casting

检定证号: **FTC210126-A**

设计型号: AB/CCC-502/05

Number of certificate of inspection

Design Type:

用户: MYTEE PRODUCTS

炉 112.5 套

该份检验证书适用: 2201029-2201030

Furnace Sets

It's suited to:

制造日期:

2020 年 12 月

Date of manufactured:

材料牌号: SCW480

炉号 Number of furnace		炉号 Number of furnace	
化学成分 Chemical composition		机械性能 Mechanical property	
碳 C max	0.20%	抗拉强度 Tensile (N/m ²) σ_b	480
锰 Mn max	0.9 - 1.5%	屈服强度 Yield (N/m ²) σ_s min	275
硅 Si max	0.50%	延伸率 Elongation (%) δ_s min	25%
硫 S max	0.035%	断面收缩率 Reduction of area (%) min	40%
磷 P max	0.035%	冲击 -40°C min	21J

识别标志:

FT

Identification marking:

无损检验:

超声波探伤

X-光探伤

Non-damage Inspection:

Ultrasonic

X-ray

热处理工艺:

Heat treatment technology:

920°C

空 冷

正火

Cooling in air

Normalized

签字 Signature: 郑业亮



日期 Date: 2021.01

扬州富通机械有限公司

Ultrasonic-Inspection Record

名称 Name	Corner Casting	型号 Type	TL BR	炉号 Number of Furnace	2201009-2201030	
材质 Material	SCW480	规格 Norms	20.28	检查范围 Scope of Inspection	1/400	
热处理状况 Condition of heat treatment	Modified	仪器型号 Instrument Type	PFUT-260/280	耦合剂 Chemical Prepsration of coupling	Machine oil	
探伤灵敏度 Flaw detection Sensitivity	6.35	探测频率 Survey frequency	2.5MHz	探伤方式 Way of Detection	A	扫描调节 Regulating Of scanning
						1:1

检验产品定位示意图

Location Sketch Map of Inspection Product

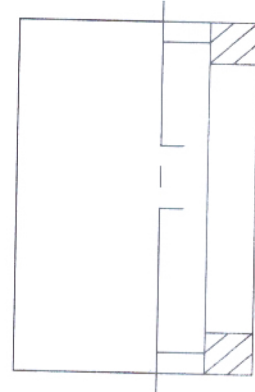
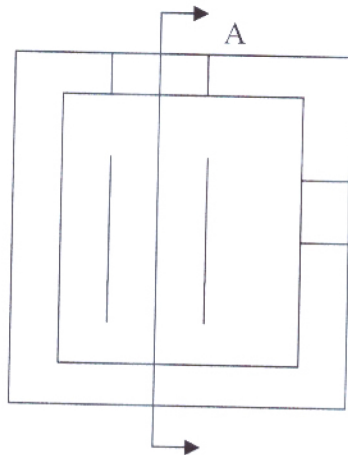

检测结论

Pection Clusion

按 ASTM-A609 / A609M-86a 级标准验收合格

产品符合 ISO1161-2016(E)要求

Checking and accepting to ASTM-A609/A609M-86a standard

After Ultrasonic inspection none of ultra poor defective wave is displayed

初探
Early detection

徐文高

复探
Again detection

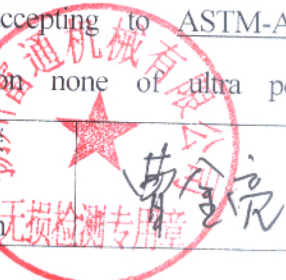

曹金亮

日期
Date

2020.12

ln

扬州富通机械制造有限公司尺寸检查表

DIMENSION CHECK SHEET

日期: DATE: 2020.12

报告发往: Report to:

MYTEE PRODUCTS

物品名称: Name of Article

集装箱角件 CORNER CASTING

图号: Drawing No.:

FTXJ03, 04

材料: Material:

SCW480

总数量: Total quantity:

112.5套

检测数量

Inspection Quantity

100%

委托号: Charge No.:

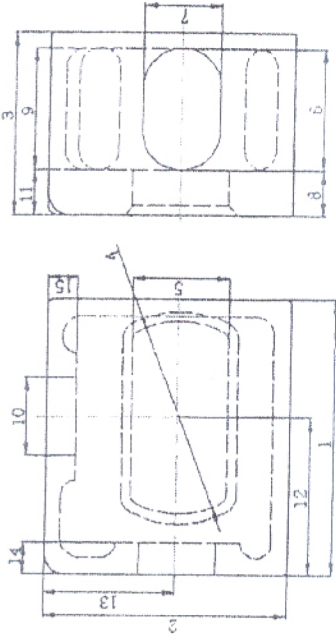

项目	标准	公差	-1.5	-1.0	-0.5	0	0.5	+1.0	+1.5
Item	Standard	Allowance							
1	178	-1			*	*	*	*	*
2	162	±0.5			*	*	*	*	*
3	118	-1		*	*	*	*	*	*
4	φ124	+1.5		*	*	*	*	*	*
5	63.5	+1.5		*	*	*	*	*	*
6	79.5	+1.5		*	*	*	*	*	*
7	51	+1.5		*	*	*	*	*	*
8	28.5	-1.5	*	*	*	*	*	*	*
9	79.5	+1.5							
10	51	+1.5							
11	28.5	-1.5	*	*	*	*	*	*	*
12	101.5	-1.5	*	*	*	*	*	*	*
13	89	-1.5	*	*	*	*	*	*	*
14	20.5	-1.5	*	*	*	*	*	*	*
15	20.5	-1.5	*	*	*	*	*	*	*

检查人 焦永芳
Rummager

复查 刘冲
Check to

验船师
Surveyor



品 质 部
Quality Control Department

扬州富通机械制造有限公司尺寸检查表

DIMENSION CHECK SHEET

日期: DATE: 2020.12

报告发往: Report to:		MYTEE PRODUCTS										
物品名称: Name of Article		集装箱角件 CORNER CASTING										
图号: Drawing No.:		FTXJ01.02										
材料: Material:		SCW480										
总数量: Total quantity:		112.5套	检测数量 Inspection Quantity							100%		
委托号: Charge No.:												
项目	标准	公差	-1.5	-1.0	-0.5	0	+0.5	+1.0	+1.5			
Item	Standard	Allowance										
1	178	-1				*						
2	162	±0.5			*	*	*					
3	118	-1			*	*	*					
4	φ124	+1.5				*	*	*	*	*	*	
5	63.5	+1.5				*	*	*	*	*	*	
6	79.5	+1.5				*	*	*	*	*	*	
7	63.5	+1.5				*	*	*	*	*	*	
8	28.5	-1.5	*	*	*	*	*	*	*	*	*	
9	79.5	+1.5				*	*	*	*	*	*	
10	51	+1.5				*	*	*	*	*	*	
11	28.5	-1.5	*	*	*	*	*	*	*	*	*	
12	101.5	-1.5	*	*	*	*	*	*	*	*	*	
13	89	-1.5	*	*	*	*	*	*	*	*	*	
14	20.5	-1.5	*	*	*	*	*	*	*	*	*	
15	20.5	-1.5	*	*	*	*	*	*	*	*	*	

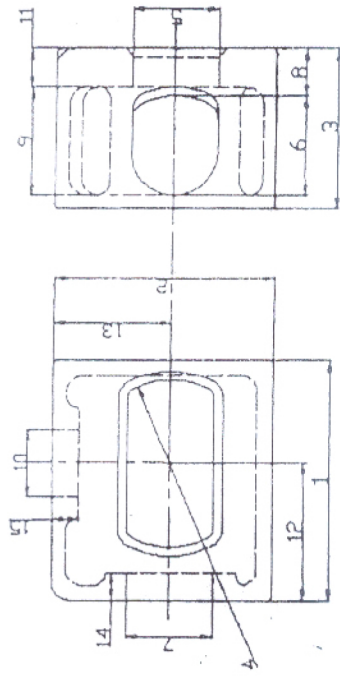

检查人 傅如松

复查 吴中亮

验船师



品 质 部
Quality Control Department

FTC 化学分析检验台帐 (Chemical Composition)

2020年 12月 日	炉号 Heat No.	分 析 结 果										备注		
		C%	SI%	Mn%	P%	S%	Cr%	NI%	Mo%	Cu%	V%		Al%	Ce%
	2201009	0.168	0.40	1.03	0.029	0.023	0.057	0.042	0.029	0.039	0.023	0.042	0.36	
	2201010	0.167	0.41	1.17	0.017	0.021	0.051	0.043	0.021	0.034	0.023	0.049	0.39	
	2201011	0.178	0.35	1.08	0.016	0.023	0.054	0.047	0.026	0.039	0.026	0.042	0.38	
	2201012	0.157	0.33	1.13	0.018	0.019	0.059	0.042	0.023	0.031	0.021	0.043	0.37	
	2201013	0.182	0.31	1.10	0.019	0.017	0.052	0.046	0.029	0.034	0.023	0.048	0.42	
	2201014	0.152	0.31	1.17	0.021	0.019	0.053	0.045	0.026	0.031	0.023	0.047	0.37	
	2201015	0.160	0.16	0.98	0.018	0.017	0.057	0.041	0.021	0.034	0.029	0.043	0.38	
	2201016	0.180	0.21	0.96	0.016	0.015	0.059	0.046	0.025	0.037	0.021	0.046	0.38	
	2201017	0.168	0.40	1.03	0.029	0.023	0.057	0.042	0.029	0.039	0.023	0.042	0.36	
	2201018	0.167	0.41	1.17	0.017	0.021	0.051	0.043	0.021	0.034	0.023	0.049	0.39	
	2201019	0.178	0.35	1.08	0.016	0.023	0.054	0.047	0.026	0.039	0.026	0.042	0.38	
	2201020	0.157	0.33	1.13	0.018	0.019	0.059	0.042	0.023	0.031	0.021	0.043	0.37	
	2201021	0.182	0.31	1.10	0.019	0.017	0.052	0.046	0.029	0.034	0.023	0.048	0.42	
	2201022	0.181	0.21	0.95	0.015	0.015	0.058	0.046	0.025	0.037	0.022	0.046	0.37	
	2201023	0.182	0.31	1.10	0.019	0.017	0.052	0.046	0.029	0.034	0.023	0.048	0.42	
	2201024	0.152	0.31	1.17	0.021	0.019	0.053	0.045	0.026	0.031	0.023	0.047	0.37	
	2201025	0.160	0.16	0.98	0.018	0.017	0.057	0.041	0.021	0.034	0.029	0.043	0.38	
	2201026	0.180	0.21	0.96	0.016	0.015	0.059	0.046	0.025	0.037	0.021	0.046	0.38	

化验员: 王金花

查: 胡梦华

验船师:

2021.1.26



FTC 机械性能检测台帐 (Mechanical Property)

2020 年 12 月 日	炉号 Heat No.	拉伸检测记录				低温冲击 (Low Temperature Impact)				备注
		拉伸强度 σ_b Tensile N/mm ²	屈服强度 σ_s Yield N/mm ²	延伸率 δ_s Elongation %	断面收缩率 ψ Reduction of area %	-40°C 冲击检测记录 (J)				
						1	2	3	平均 Average Value	
	2201009	558	342	28.2	41.8	30	37	31	32	
	2201010	508	310	37.2	52.9	39	37	38	38	
	2201011	492	302	32.2	48.2	34	30	26	30	
	2201012	504	289	31.3	54.1	40	46	34	40	
	2201013	558	342	28.2	41.8	30	37	31	32	
	2201014	508	310	37.2	52.9	39	37	38	38	
	2201015	492	302	32.2	48.2	34	30	26	30	
	2201016	504	289	31.3	54.1	40	46	34	40	
	2201017	529	338	29.1	45.0	42	48	38	43	
	2201018	542	345	29.0	42.3	28	35	34	32	
	2201019	561	342	28.0	48.2	36	38	42	39	
	2201020	493	294	29.6	52.3	45	42	38	41	
	2201021	495	306	30.7	50.0	30	42	24	32	
	2201022	499	294	30.1	52.3	35	48	30	37	
	2201023	529	338	29.1	45.0	42	48	38	43	
	2201024	542	345	29.0	42.3	29	32	34	31	
	2201025	561	342	28.0	48.2	36	38	42	39	
	2201026	493	294	29.6	52.3	44	42	38	41	

检验员：屠庆香

查：胡梦华

验船师：

2021.1.18





American Bureau of Shipping

Container Corner Casting Production Certificate

(This Certificate is valid only when endorsed by an ABS Surveyor)

Date: 28 April 2021

Certificate No.: SQ4739893-F

Design Type No.: AB/CCC- 502 / 05 -

THIS IS TO CERTIFY that the herein described Container Corner Castings have been manufactured and tested in accordance with the American Bureau of Shipping Rules for Certification of Cargo Containers and with dimensional requirements of ISO 1161-2016(E)...

Manufacturer: [REDACTED]

Purchaser: MYTEE PRODUCTS

These corner castings were manufactured in accordance with drawings reviewed on Aug 11,2005

Reference no. T-8-7 5705, under General Arrangement drawing number FTXJ.01.02.03.04

This certificate is for 375 sets of corner castings, model number FTX-ISO, manufactured during the month of April 2021. These corner castings comply with material specification SCW480

as evidenced by the chemical and mechanical test data attached to this certificate.

Nondestructive Testing: Radiographic Ultrasonic Heat Treatment Condition: Annealed Normalized Normalized and tempered

These castings have been thoroughly inspected and tested at each stage of manufacture by our inspection department under quality control surveillance of the American Bureau of Shipping and are marked as follows:

Serial/heat No.: See attached manufacturer's certificate no.FTC210428-F Dated 2021.04

28 April 2021 Date

Zhang Ping In Charge of Quality Control

The undersigned has carried out quality control surveillance at the above plant and considers these corner castings to be eligible to become part of an ABS/ISO certified container.

28 April 2021 Date

Chen Gang(7118) Surveyor

NOTE: This Certificate evidences compliance with one or more of the rules, guides, standards or other criteria of American Bureau of Shipping and is issued solely for the use of the bureau, its committees, its clients or authorized entities. This Certificate is a representation only that the vessel, structure, item of material, equipment, machinery or any other item covered by this Certificate has been examined for compliance with, or has met one or more of the Rules, guides, standards or other criteria of American Bureau of Shipping. The validity, applicability and interpretation of this Certificate is governed by the Rules and Standards of American Bureau of shipping which shall remain sole judge thereof. Nothing contained in this Certificate or in any Report issued in contemplation of this Certificate shall be deemed to relieve any designer, builder, owner, manufacturer, seller, supplier, repairer, operator or other entity of any warranty express or implied.

扬州富通机械有限公司



集装箱铸造角件产品检验合格证书

Certificate of inspection eligible of container corner casting

检定证号: **FTC210428-F**

设计型号: AB/CCC-502/05

Number of certificate of inspection

Design Type:

用户: MYTEE PRODUCTS

炉 375 套

Furnace Sets

该份检验证书适用: 2210409-2210414

It's suited to:

2021 年 4 月

制造日期:

Date of manufactured:

材料牌号: SCW480

炉号 Number of furnace	化学成分 Chemical composition	炉号 Number of furnace	机械性能 Mechanical property
	碳 C max 0.20%		抗拉强度 Tensile (N/m ²) σ_b 480
	锰 Mn max 0.9 -1.5%		屈服强度 Yield (N/m ²) σ_s min 275
	硅 Si max 0.50%		延伸率 Elongation(%) δ_s min 25%
	硫 S max 0.035%		断面收缩率 Reduction of area (%) min 40%
	磷 P max 0.035%	冲击	-40°C min 21J

识别标志:

FT

Identification marking:

无损检验:

超声波探伤

X-光探伤

Non-damage Inspection:

Ultrasonic

X-ray

热处理工艺:

Heat treatment technology:

920°C

空冷

正火

Cooling in air

Normalized

签字 Signature: 郑业亮



日期 Date. 2021.04

扬州富通机械有限公司

Ultrasonic-Inspection Record

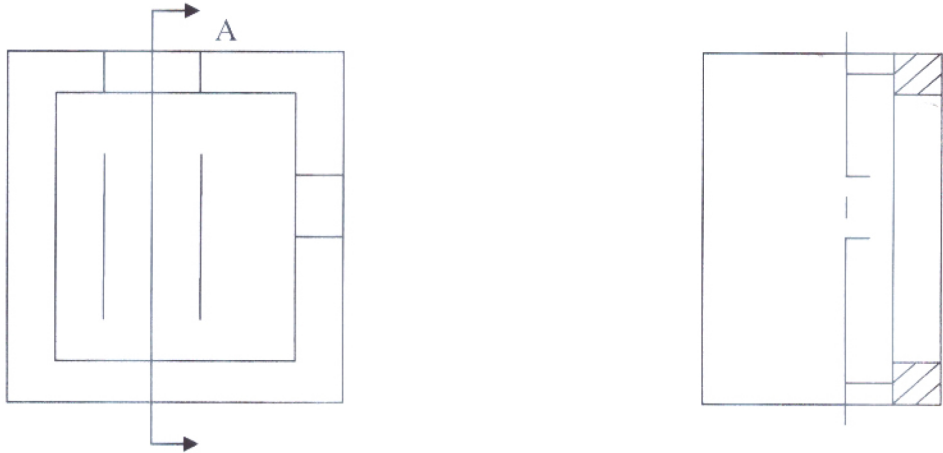
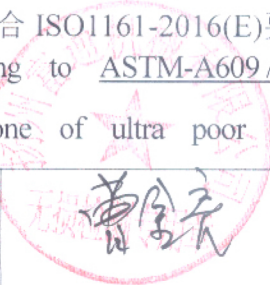
名称 Name	Corner Casting	型号 Type	TR TL BLBR	炉号 Number of Furnace	2210409-2210414	
材质 Material	SCW480	规格 Norms	20.28	检查范围 Scope of Inspection	1/400	
热处理状况 Condition of heat treatment	Modified	仪器型号 Instrument Type	PFUT- 260/280	耦合剂 Chemical Prepsration of coupling	Machine oil	
探伤灵敏度 Flaw detection Sensitivity	6.35	探测频率 Survey frequency	2.5MHz	探伤方式 Way of Detection	A	扫描调节 Regulating Of scanning 1:1
检验产品定位示意图 Location Sketch Map of Inspection Product						
检测结论 Pection Clusion	<p>按 <u>ASTM-A609 / A609M-86a</u> 级标准验收合格</p> <p>产品符合 ISO1161-2016(E)要求</p> <p>Checking and accepting to <u>ASTM-A609 / A609M-86a</u> standard</p> <p>After Ultrasonic inspection none of ultra poor defective wave is displayed</p>					
初探 Early detection	徐兴高	复探 Again detection			日期 Date	2021.4

Handwritten signature

